



PROTECTING WHAT MATTERS

# Pig DOT Packaging Instructions

1



**ERECT BOX**

Pull out sides and push bottom down until tab engages

2

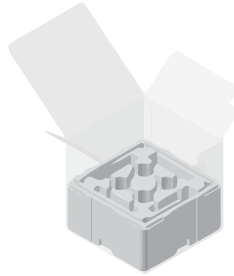

**PUT IN BOTTOM FOAM**

Place bottom foam into the base of the box

3

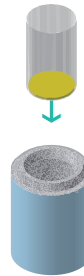

**LINERS & FOAM DISC**

Ensure liner and foam disc are in each pig base

Liner # V004282 (Optional)  
Foam Disc # V003673

4

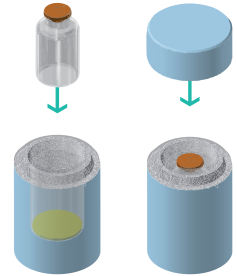

**INSERT VIALS**

Place product filled vial into pig base and put on lid

5

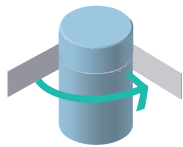

**TAPE LID**

Tape lid to base all the way around

Tape # V004292

6



**SEAL INTO BAG**

Put pig into plastic bag and seal

Bag # V004020

7

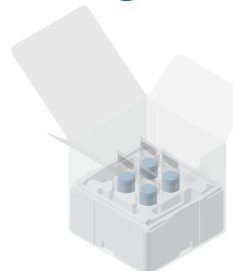

**SET PIGS INTO FOAM**

Put desired number of bagged pigs into bottom foam

8

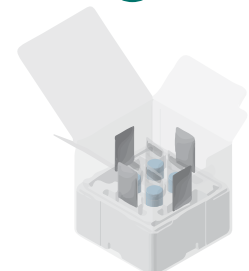

**ADD ICE PACKS (OPTIONAL)**

Add ice packs to the 4 outer slots in the lower foam base if needed

9

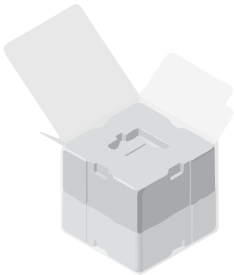

**PUT IN TOP FOAM**

Add top foam piece securely to cover the pigs

10

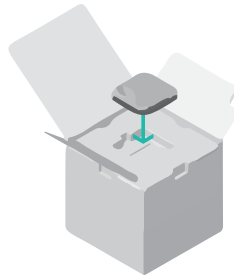

**PLACE TRACKER (OPTIONAL)**

Add tracking device to top insert of foam cover

11



**CLOSE BOX**

Close top of box and engage flap and locking tab



**PLEASE CONTACT US IF YOU HAVE ANY QUESTIONS.**

Note: Packaging method and materials used must be done in accordance with approved DOT testing reports. No alternate materials allowed. Contact us for a copy of the test report as needed.